

unisun
energy

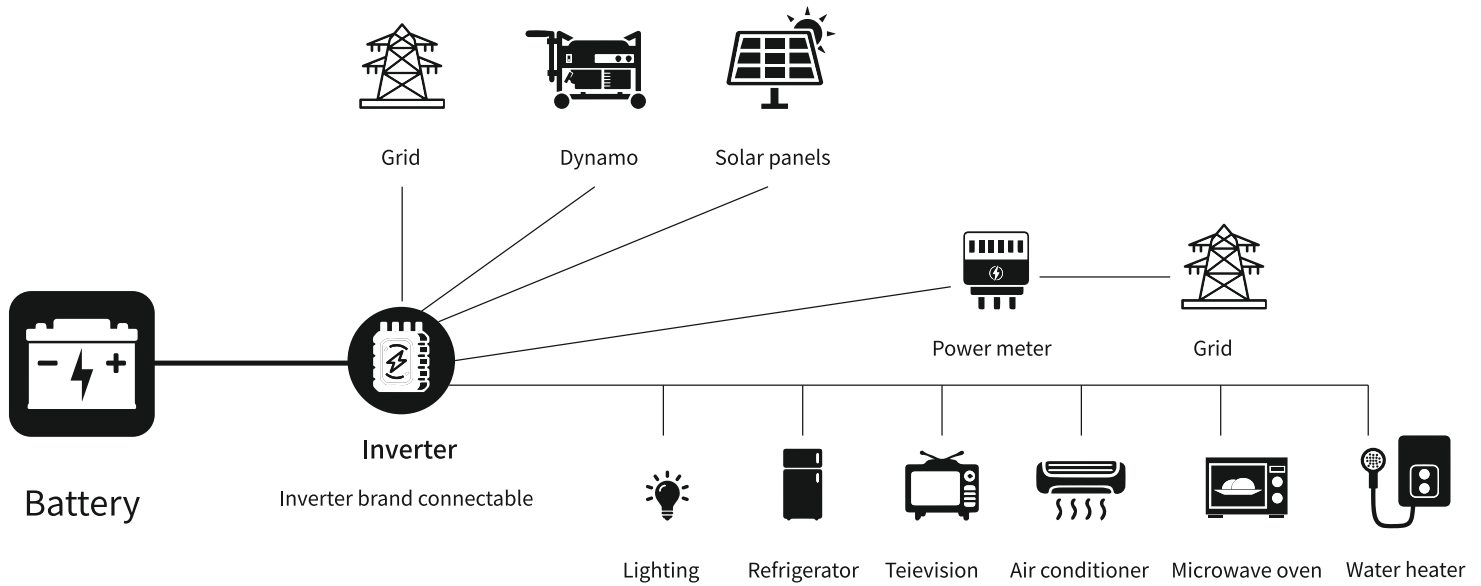

Application Diagram



Inverter brand connectable

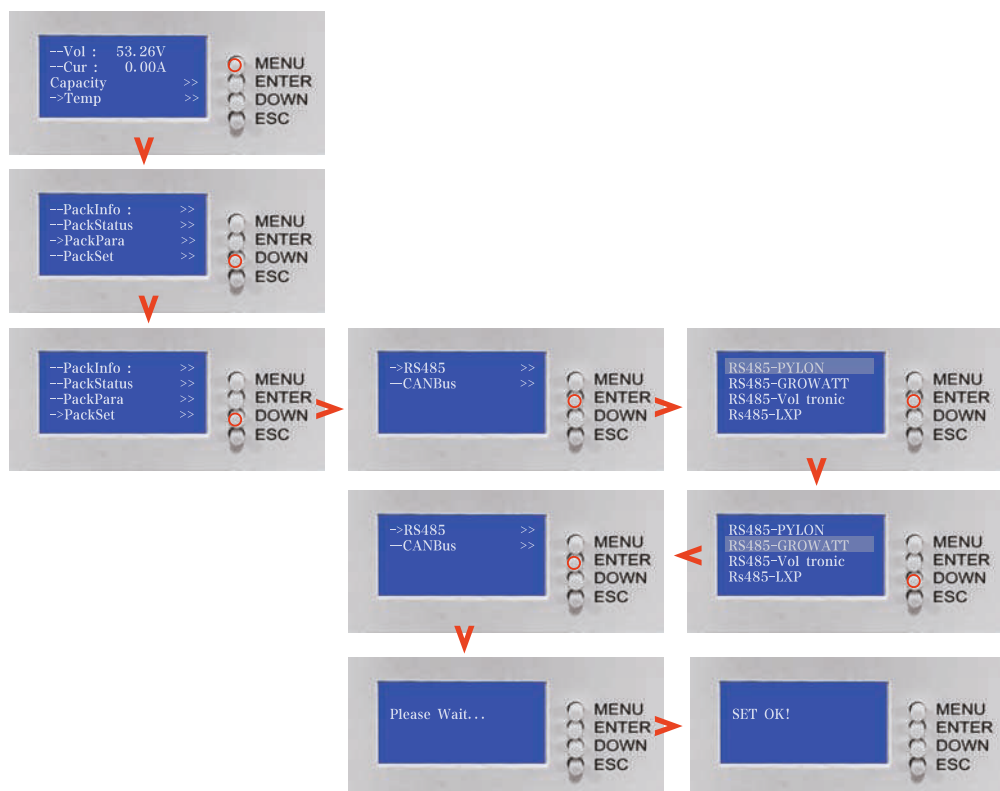

51.2V300AH

51.2V 15KWH

LiFePO4 Battery Pack

Storage battery for household use



Rated Capacity	300Ah
Rated Voltage	DC51.2V
Rated Energy	15360Wh
Operating Voltage	44.8V ~ 58.4V
Max. Charge Current	75A
Max. Discharge Current	150A
Peak Current	200A
Discharge Temp	-10℃ ~ 55℃
Charge Temp	0℃ ~ 55℃
Dimension	L850*W390*H255(mm)
Weight	113Kg
Internal Resistance	≤30mΩ
Cycle Life	6000
Communication	CAN / RS485
Warranty	5 years

Wiring port description

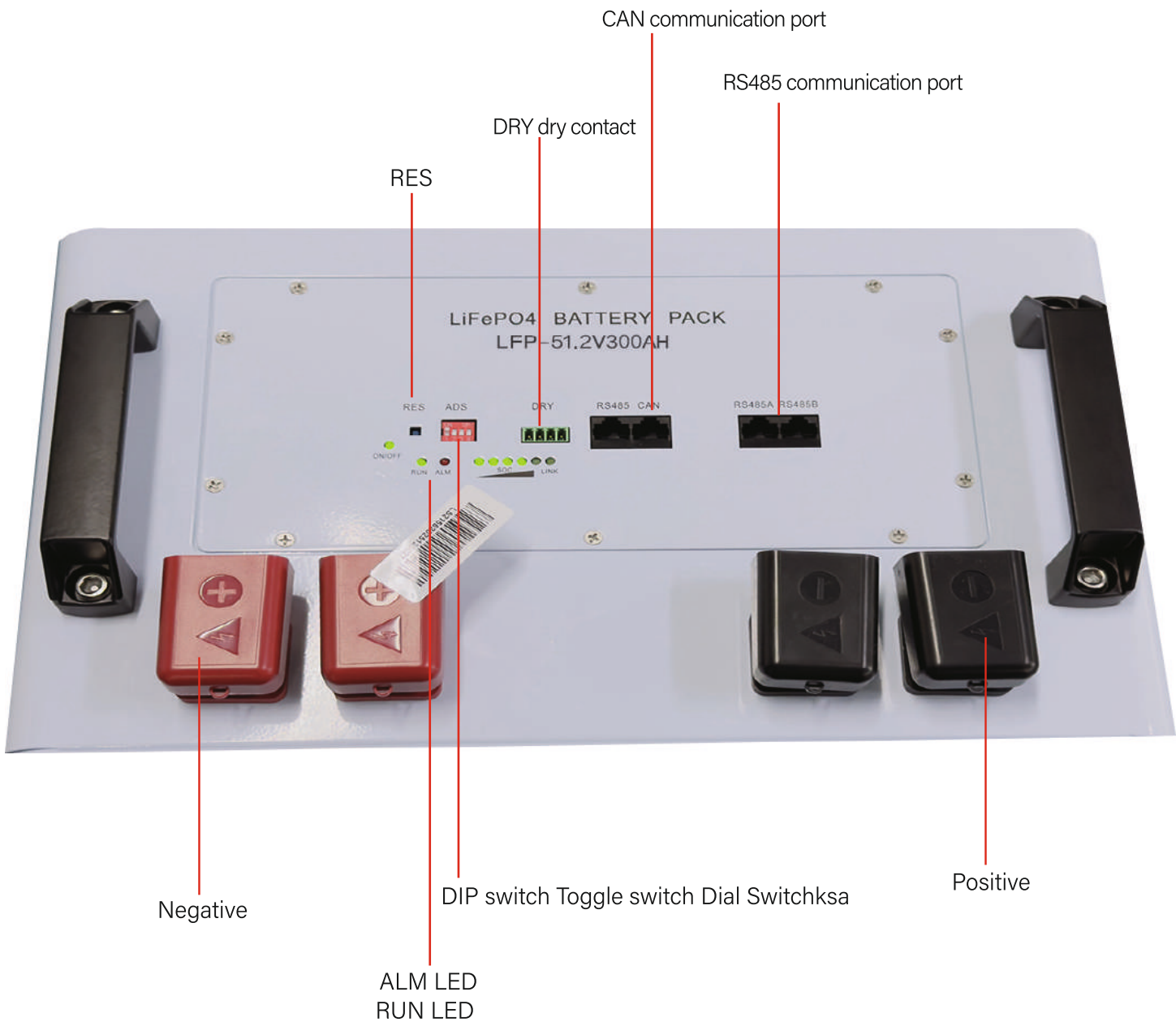

product accessories



Power Cables*2



COM Cable*1



CE certification
& moisture-proof agent

Parallel diagram

- Positive electrode wire
- Negative electrode wire
- Communication line

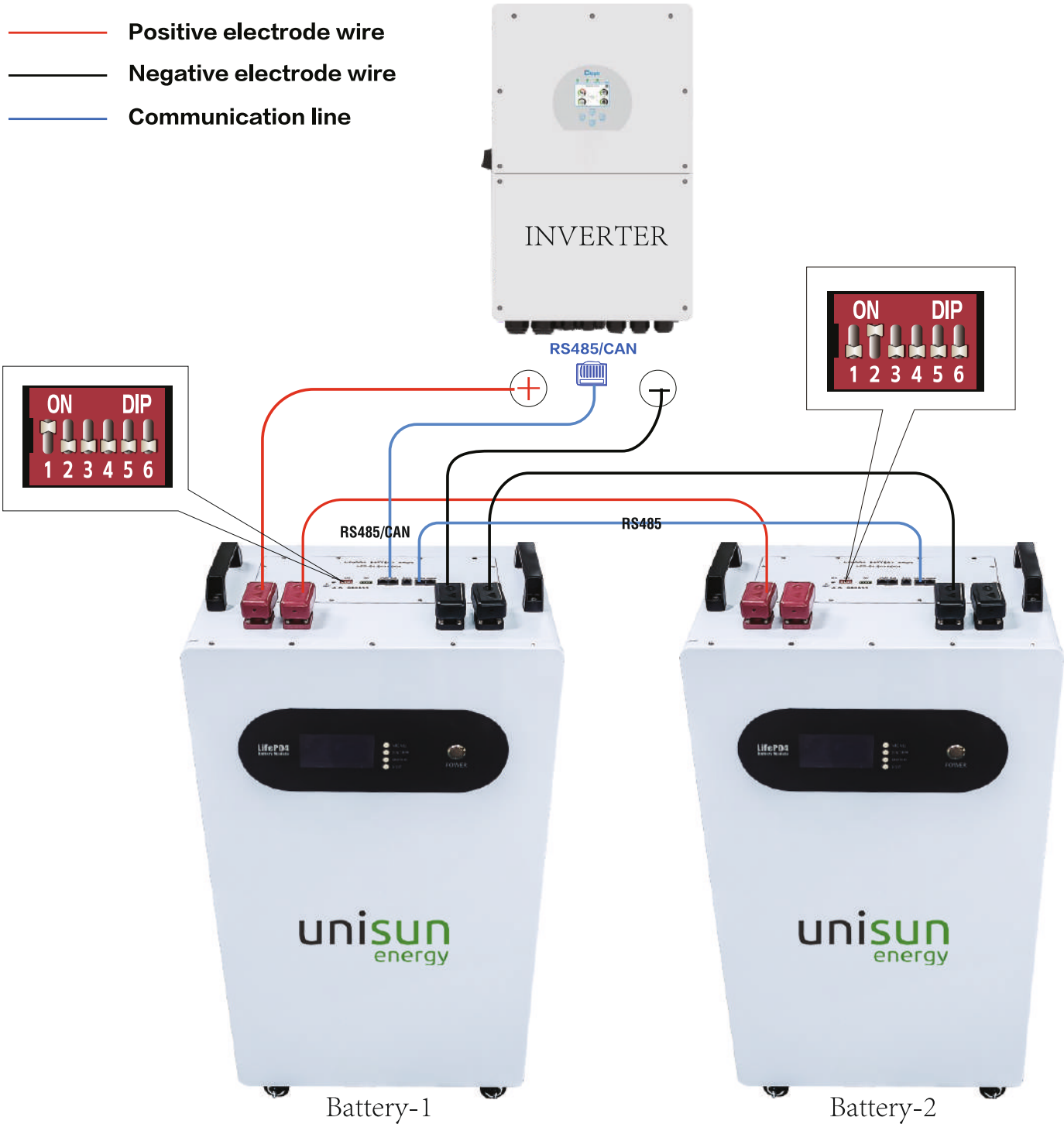

Parallel diagram

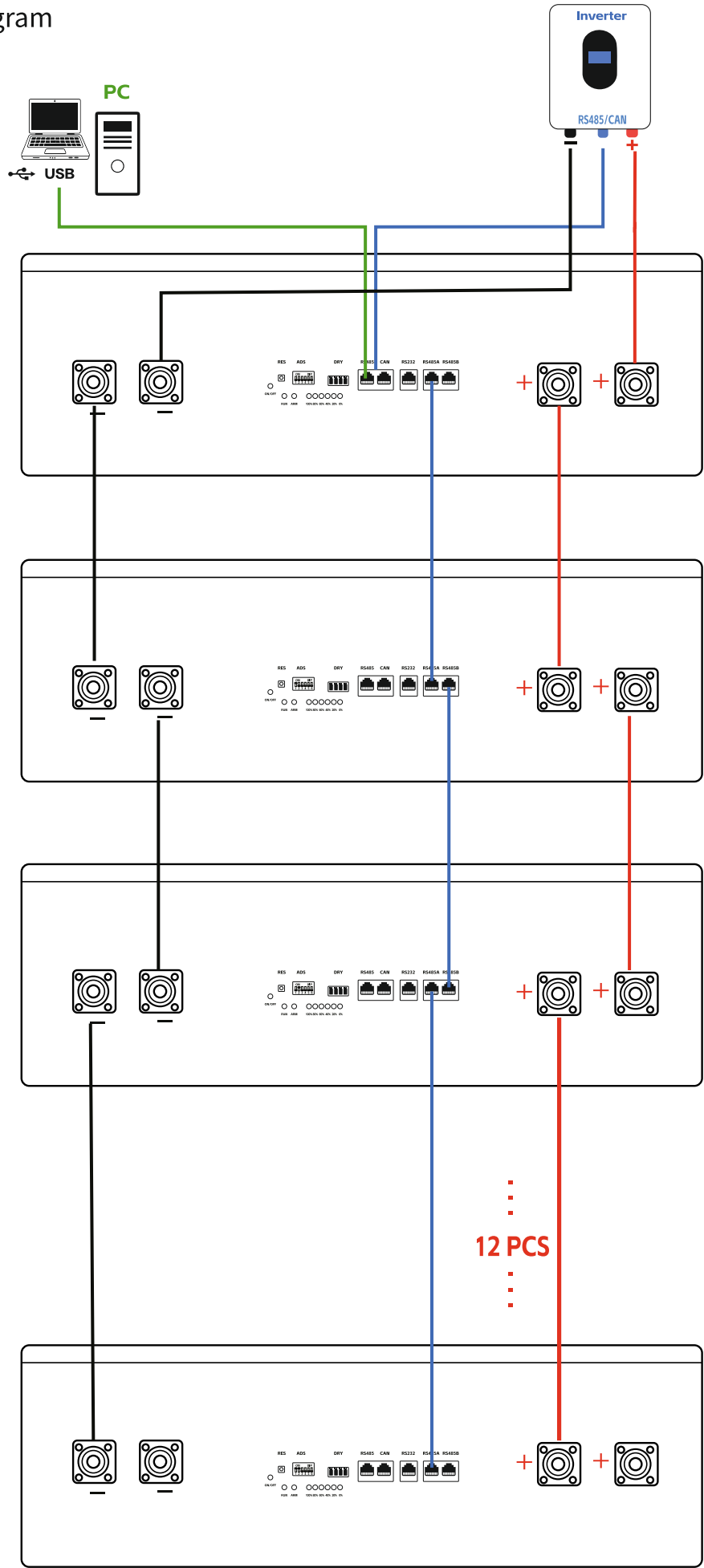

Parallel diagram

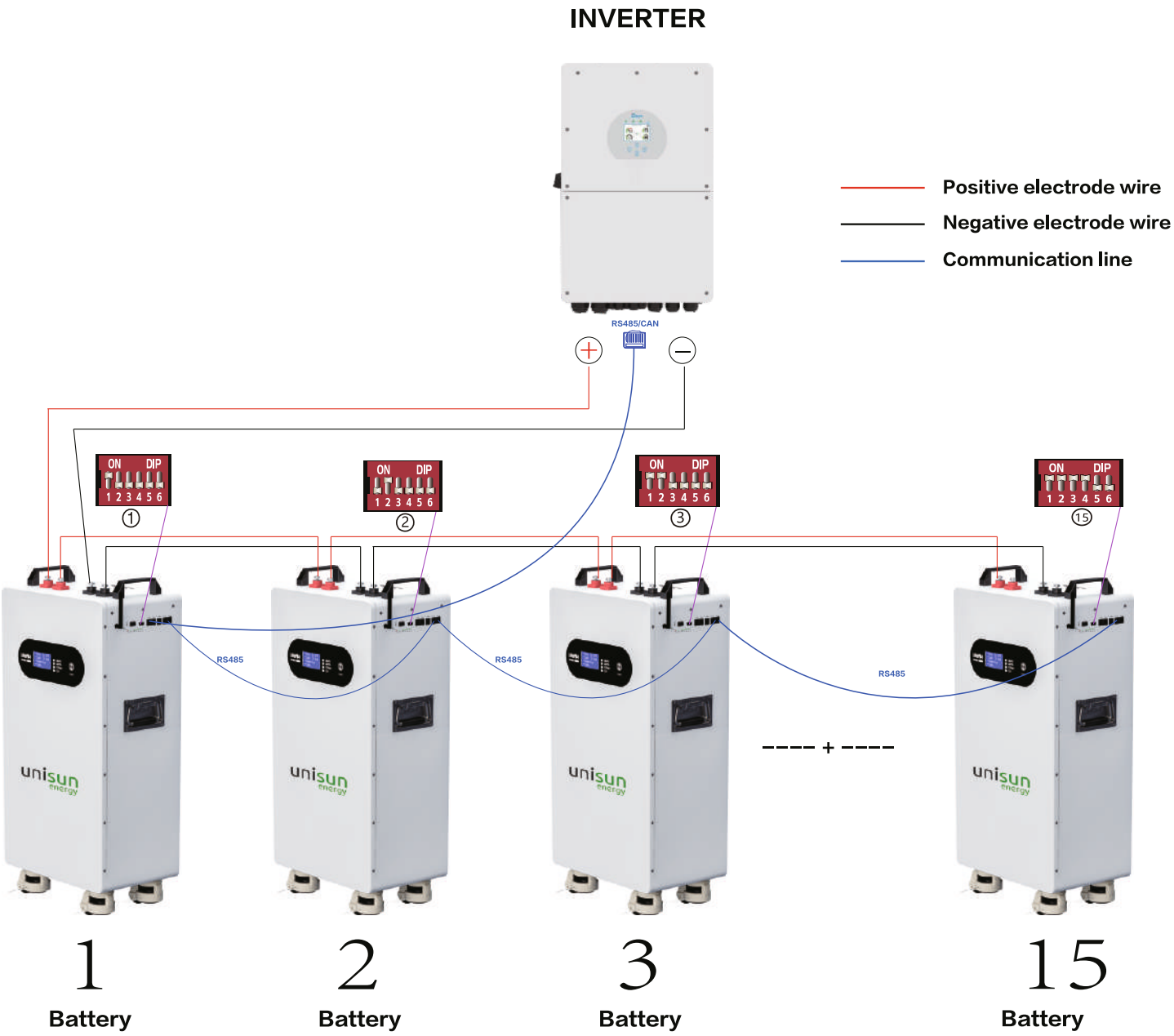

product accessories



Power Cables*2



COM Cable*1



CE certification
& moisture-proof agent

RS485/CAN/,232 Interface Definiton

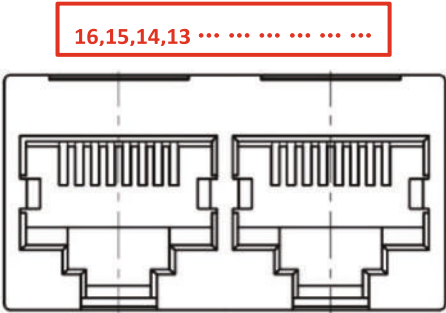
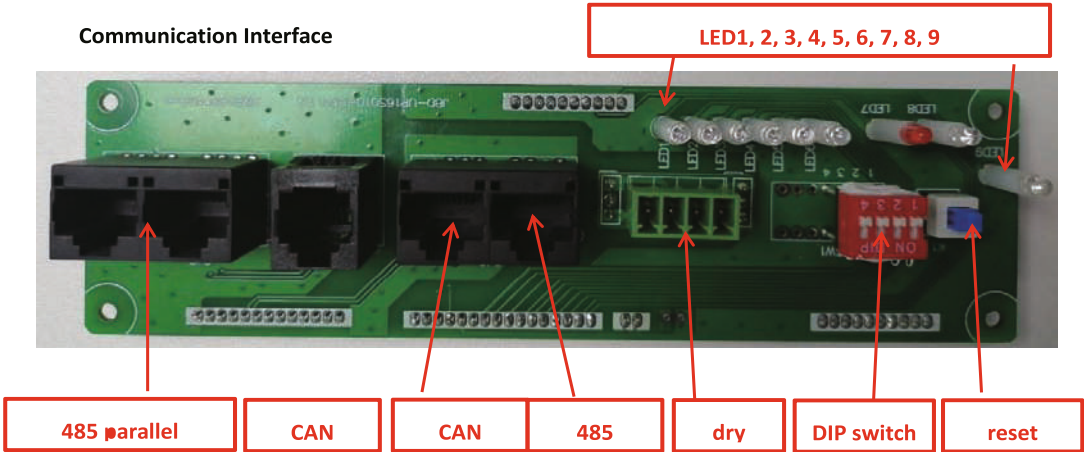

RS485--use8P8CVerticalRJ45socket		CAN--use8P8CVerticalRJ45socket	
RJ45pin	Definition	RJ45pin	Definition
1, 8	RS485-B1	9, 10, 11, 14,	NC
		16	
2, 7	RS485-A1	12	CANL
3, 6	GND	13	CANH
4, 5	NC	15	GND

CANandRS485interface

RS485--use8P8CVerticalRJ45socket		RS485--use8P8CVerticalRJ45socket	
RJ45pin	Definition	RJ45pin	Definition
1, 8	RS485-B	9, 16	RS485-B
2, 7	RS485-A	10, 15	RS485-A
3, 6	GND	11, 14	GND
4, 5	NC	12, 13	NC

Parallel communication port

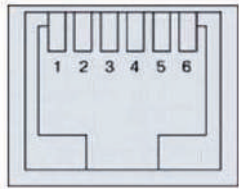

232 communication port

RS232--use6P6CVerticalRJ11socket	
RJ11pin	Definition
1,2, 6	NC
3	TX (vener)
4	RX (vener)
5	GND

◆ STEP 1: Add



Software Download



Click "Add"

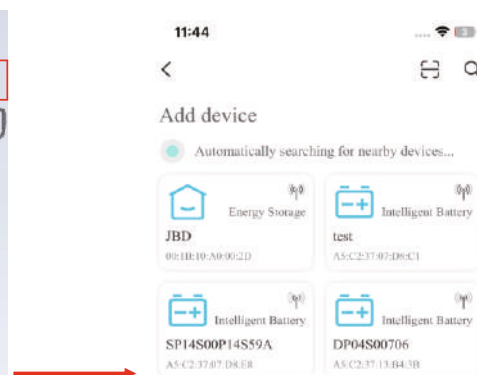

BT Scanned "Device List"

◆ STEP 2: Connection



Click "Energy Storage"

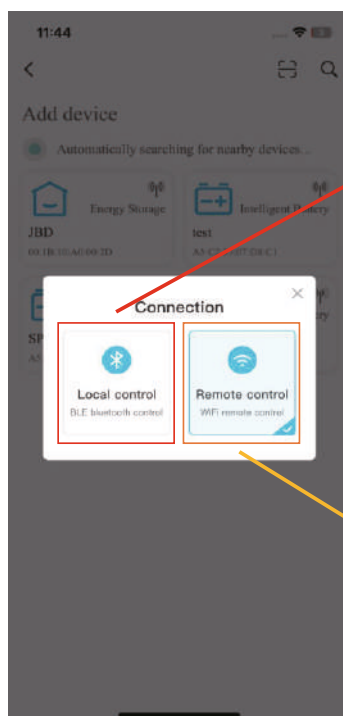

Check "Connection"

Bluetooth

- ◆ Select a Bluetooth connected device to read data and control the device near the device
- ◆ Disadvantages: Away from the device, unable to connect the device, read data, control the device

WiFi

- ◆ To select WiFi connection, you need to configure the device with a WiFi (2.4GHz) network
- ◆ Once the distribution network is completed, as long as the WiFi is online, data can be read and equipment can be controlled in real time

◆ STEP 2-1: WiFi Connection

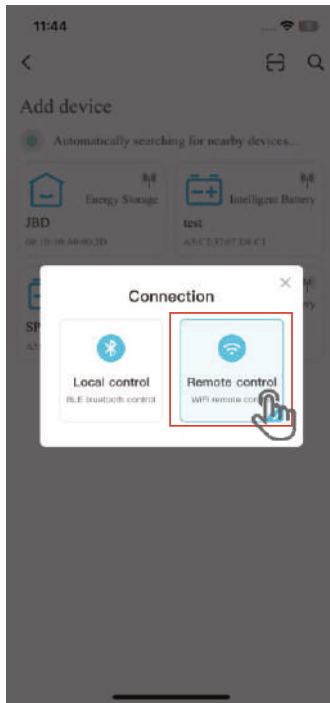

Click "Remote Control"

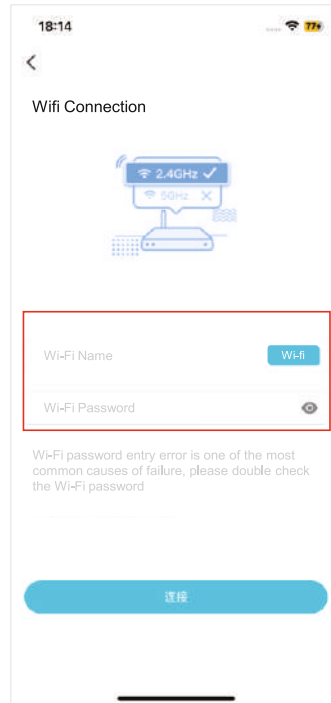

WiFi Settings

Keynote

- ◆ WiFi distribution network needs to be connected to the 2.4GHz WiFi
- ◆ WiFi distribution network is successful, will return a prompt (success or failure);
- ◆ Distribution Successful-Jump-Enter Device Page

◆ STEP 3: Energy Storage · Summary Bindig & Untie

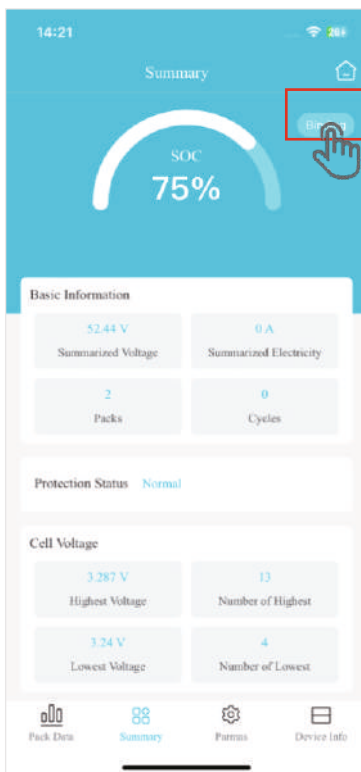

Click "Binding"

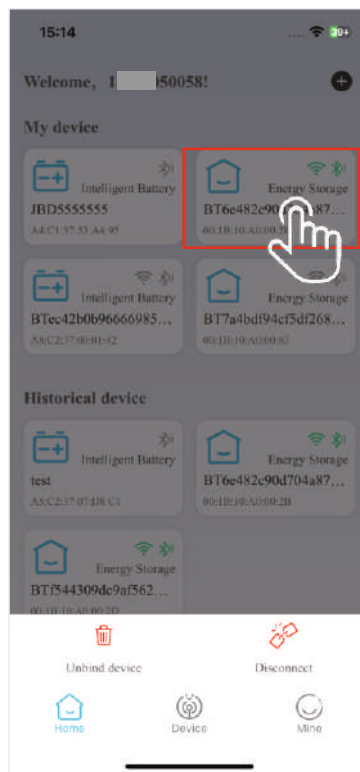

Untie · Long Press Device - Unbind Device

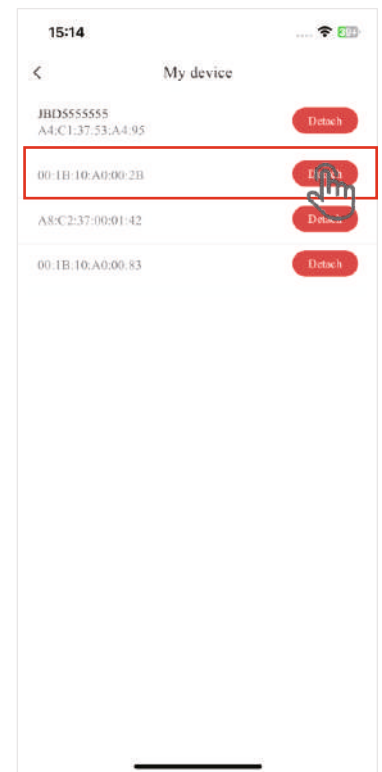

Untie· Mine - My Device -Detach

◆ STEP 4: Energy Storage · Summary

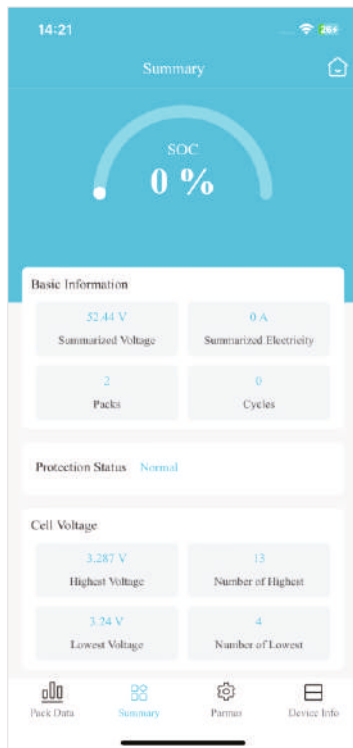

Device connection (Bluetooth or WiFi) successful
Enter Energy Storage · Summary

After Enter "Energy Storage"
As shown on the right

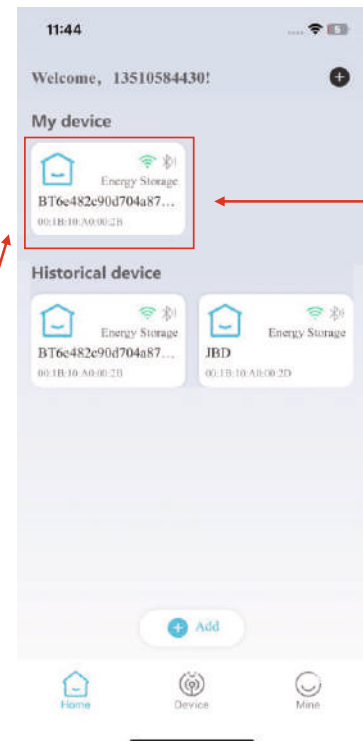

User Binding

Energy Storage · Summary

◆ STEP 5: Energy Storage · Pack Data

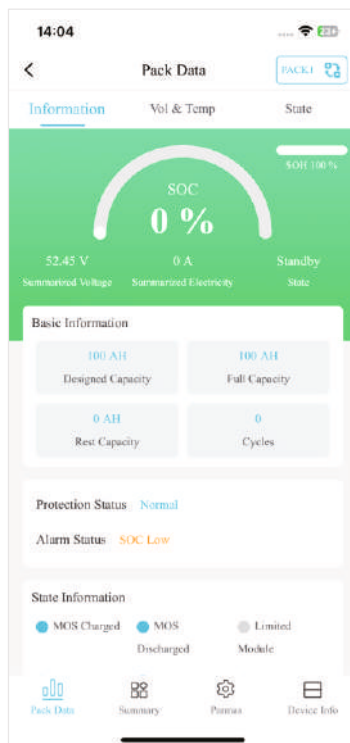

PACK · Information

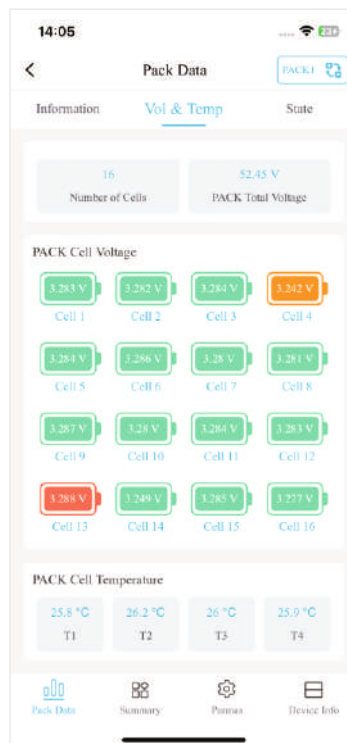

PACK · Vol & Temp

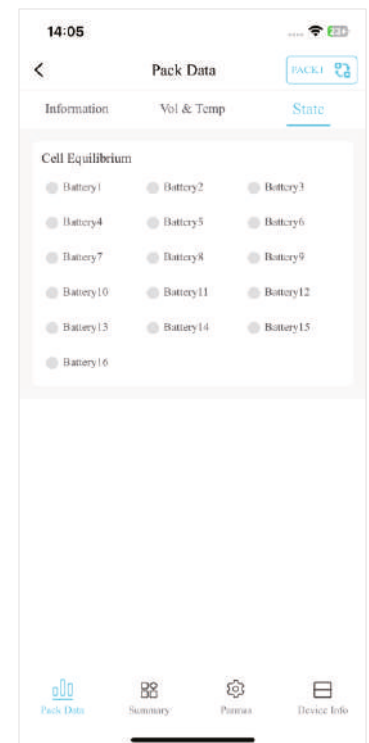

PACK · State

◆ STEP 5-1: Energy Storage Switch Pack Data

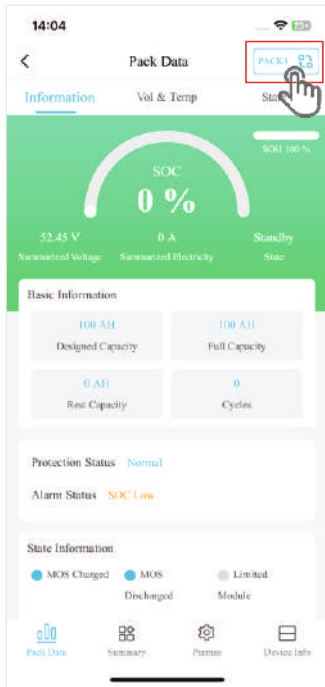

Switch "PACK "

- Selected + Online PACK1
- Selected + Online PACK1
- No Selected + Online PACK2
- No Selected Offline PACK3

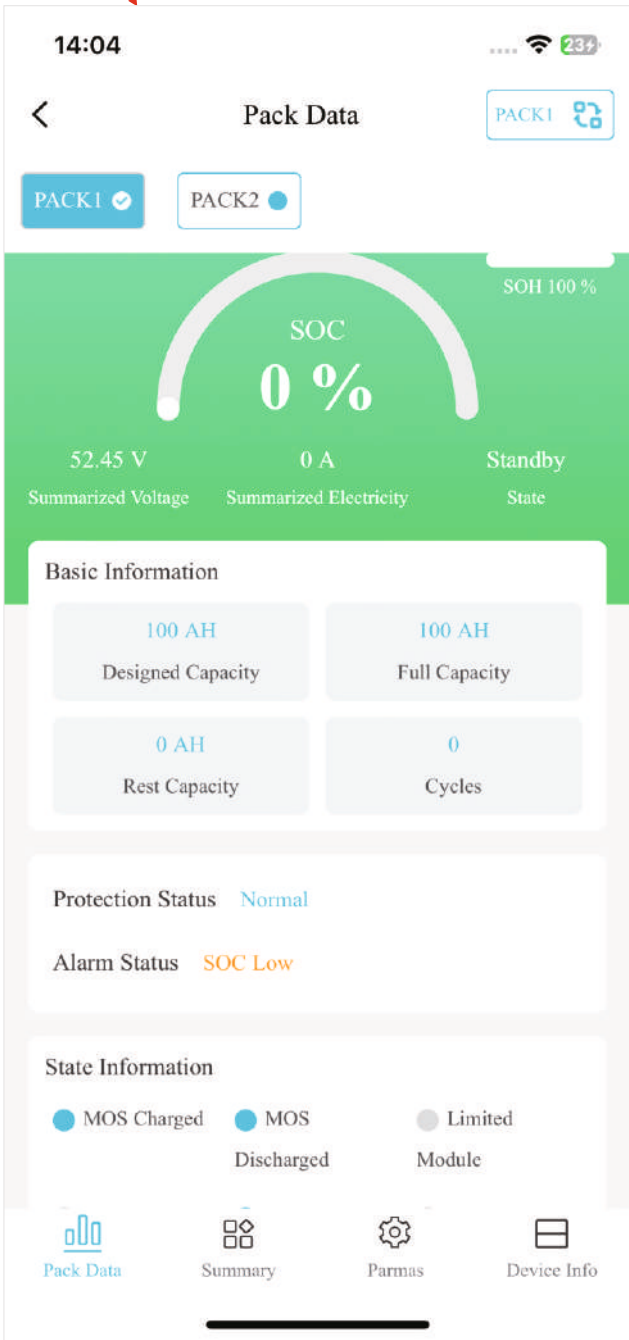

◆ STEP 6: Energy Storage · Params / Device Info-OTA

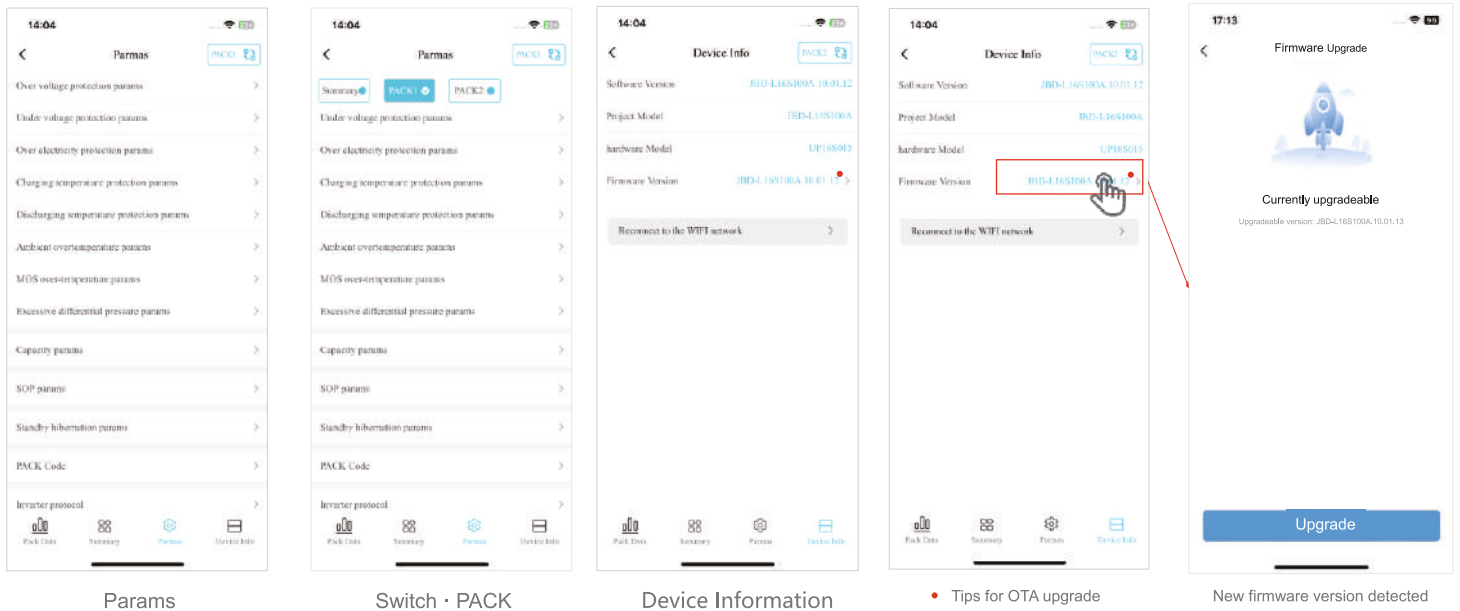

◆ STEP 7: Energy Storage Device Info- Reconnect the WiFi

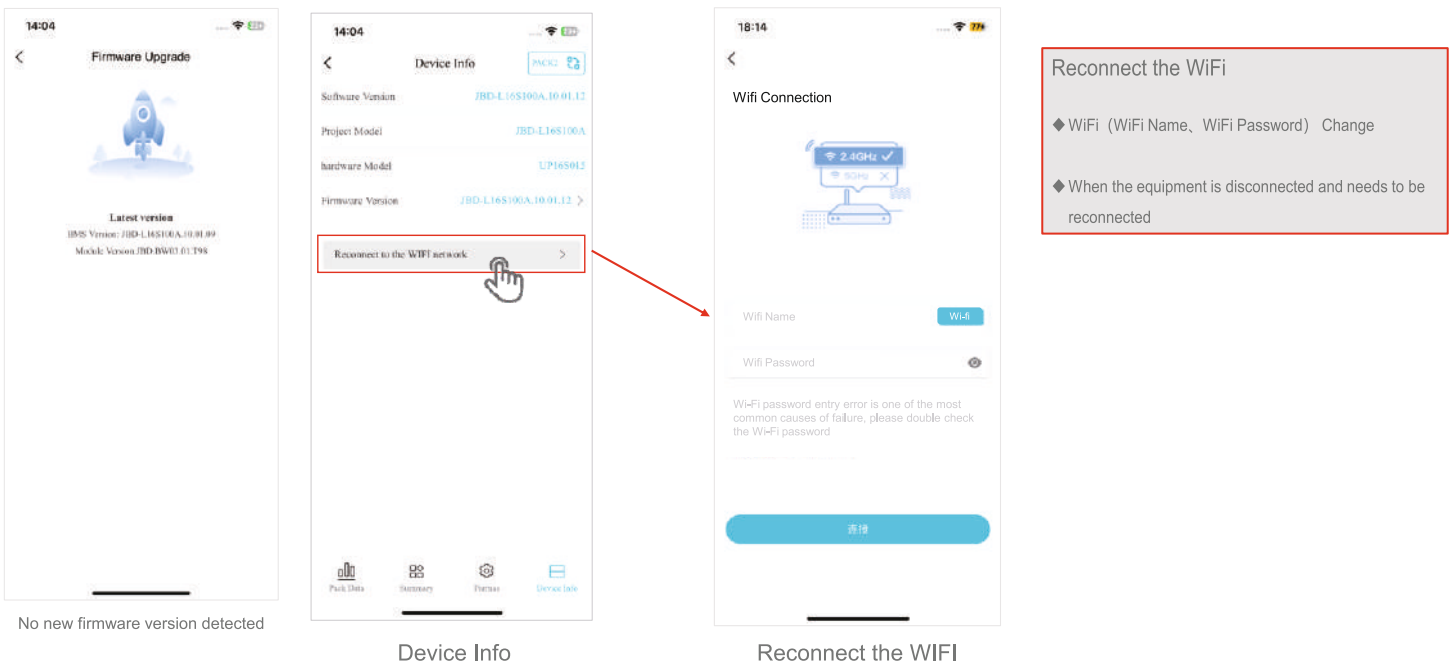

Code drawing

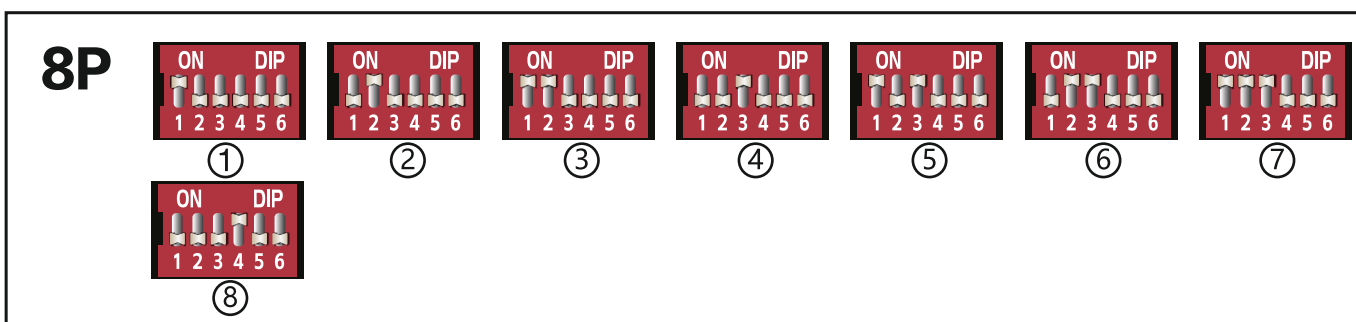
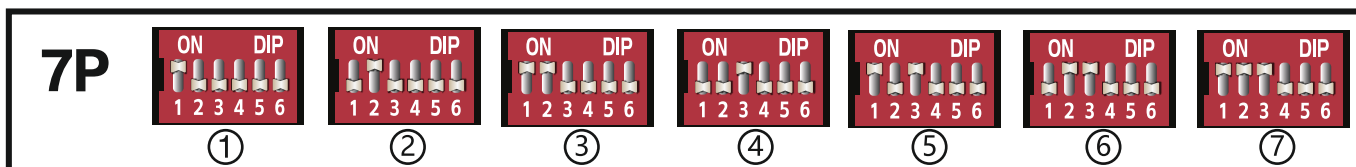
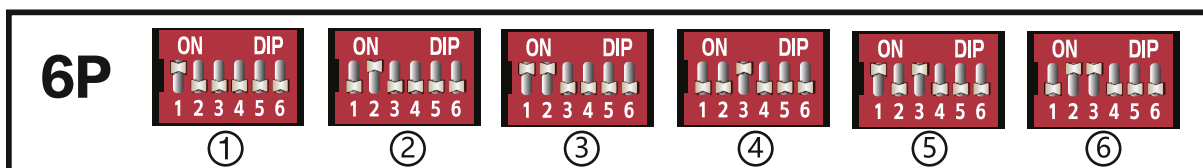
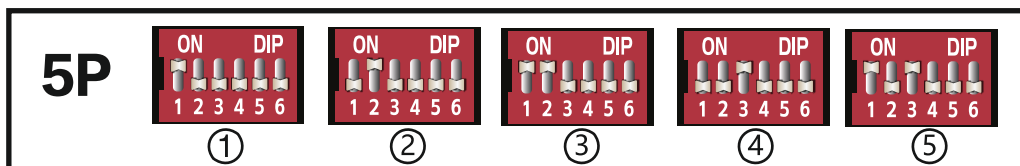
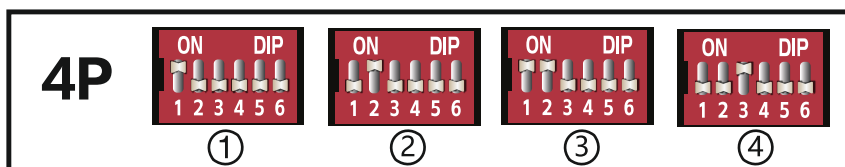
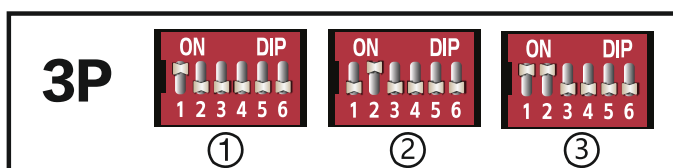
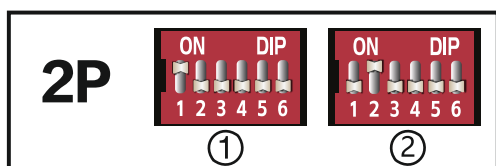
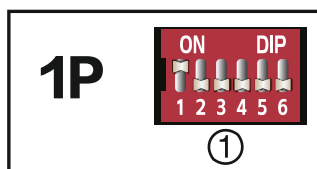

9P

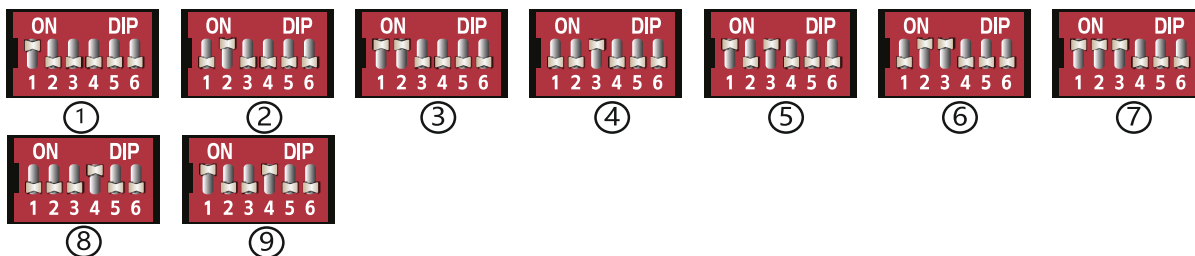

10P

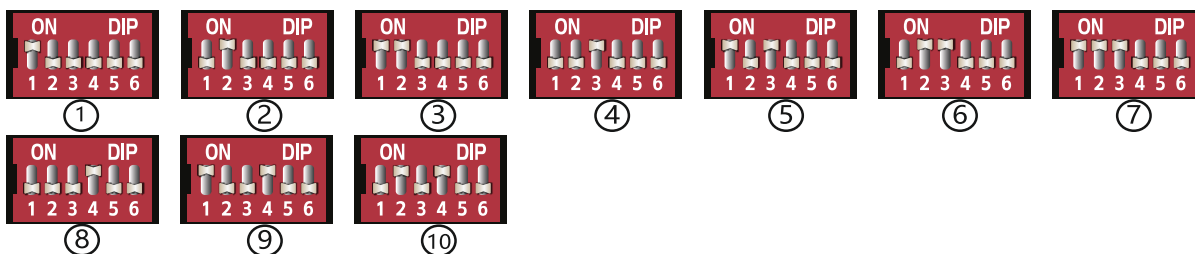

11P

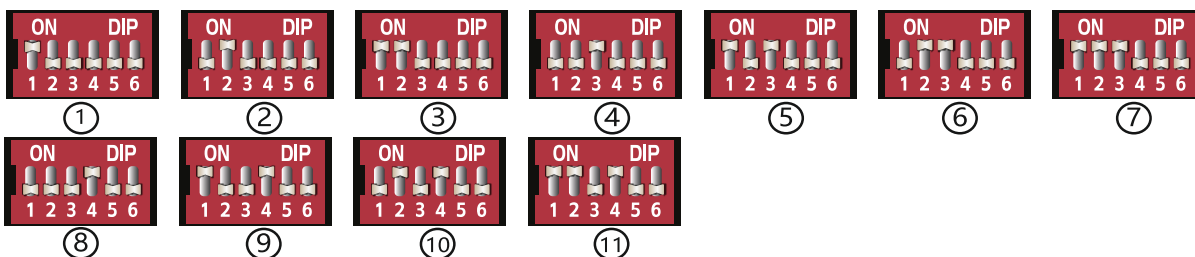

12P

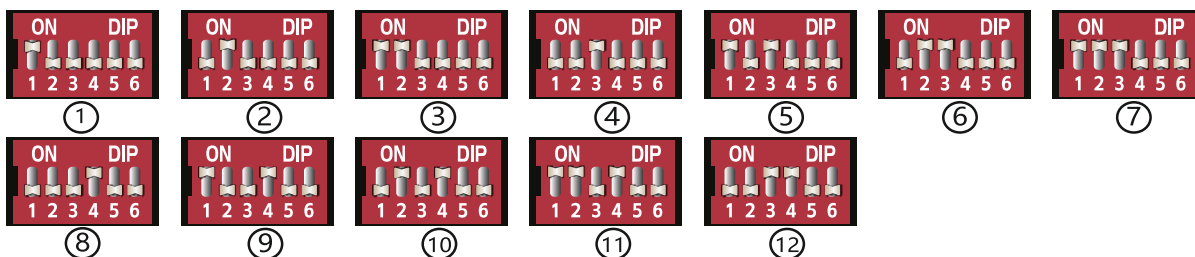

13P

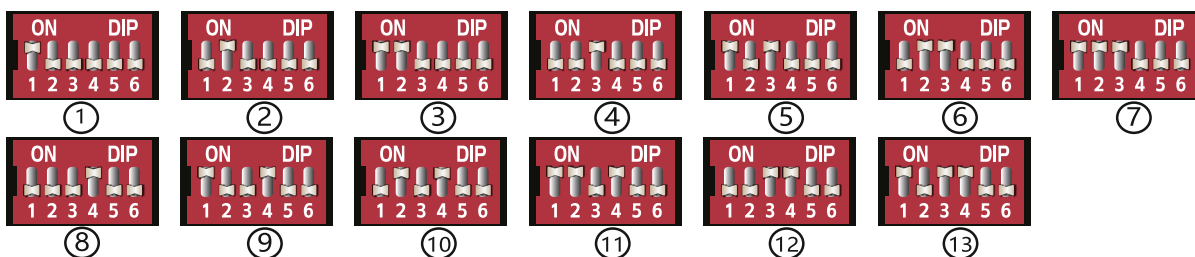

14P

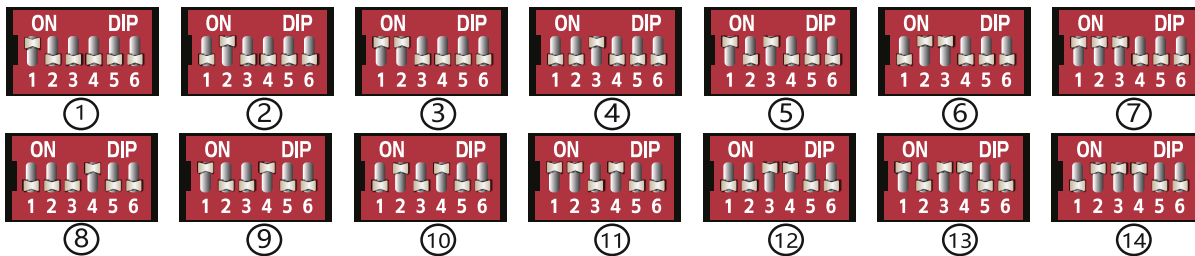

15P

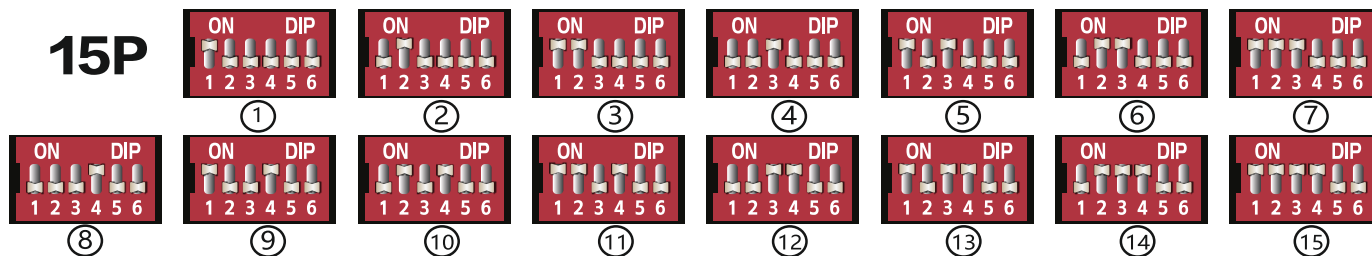

Precautions

If there is inconsistency in voltage and capacity when connected in parallel, it means that the batteries are connected in parallel. Cut off the charging load, turn on the battery switch, and let the batteries charge each other. Prepare a step-by-step diagram.

If it suddenly shuts down, it can be activated by charging or discharging first.

3. (And other solutions to common problems)

Matters needing attention

1. After using up the electricity, charge within 24 hours
2. Turn off the machine first, then connect the positive and negative terminals of the battery to avoid short circuits.
3. Do not expose the battery to high temperatures, stay away from heating and fire sources
4. Do not put the battery in water to avoid getting wet.
5. Do not disassemble the battery without authorization
6. Keep the battery in a cool and dry state. If the battery is not in use, please charge it every 3 months
7. Charging and discharging voltage, charging and discharging current should be set according to the factory label
- 8. Note that the battery must be turned off before disassembly and assembly**
- 9. When connecting the battery to the inverter, the battery must be turned on first and then the inverter must be turned on**
- 10. It is strictly prohibited to open the battery without authorization, Warranty void if seal is broken**



Pay attention to retention

Warranty Card

Model: _____

Pohone: _____

Series: _____

E-mail: _____

Purchase address: _____

Contact address: _____

Purchasing date: _____

1. If this product malfunctions while in use from the date of purchase, please contact our company's business. This certificate should be presented during warranty

2. Machine malfunctions caused by the following reasons are not covered by the free warranty:

- A. Component damage caused by human factors
- B. Damage caused by personal transportation
- C. Personal accidental damage to products
- D. Force majeure: such as damage caused by natural disasters
- E. Third party damage
- F. Poor power supply environment damage
- G. Damage caused by foreign objects entering, repair, etc
- H. Damaged items such as self disassembly, repair, etc

3. We are not responsible for the failure of other equipment directly or indirectly caused by product reasons

1. If this product malfunctions while in use from the date of purchase, please contact our company's business. This certificate should be presented during warranty

2. Machine malfunctions caused by the following reasons are not covered by the free warranty:

- A. Component damage caused by human factors
- B. Damage caused by personal transportation
- C. Personal accidental damage to products
- D. Force majeure: such as damage caused by natural disasters
- E. Third party damage
- F. Poor power supply environment damage
- G. Damage caused by foreign objects entering, such as water, liquids, etc
- H. Damaged items such as self disassembly, repair, etc

3. We are not responsible for the failure of other equipment directly or indirectly caused by product reasons

unisun
energy